

INFINITEPLAY



NO
LIMITS
SYSTEM



CONTENTS

01 THE SYSTEM



- 06 No limits system
- 08 Functions and services
- 10 Applications

02 HOME SECURITY



- 14 VIDEO DOOR PHONE SYSTEM
- 16 Entrance panels **Flat**
- 18 Colours
- 20 Flat Flush mount **Flat**
- 22 Monitors **Next**
- 24 System components
- 26 Building Management
- 28 System programming
- 30 Open to standard SIP
- 32 System diagnostics
- 33 Connection diagrams

COMPONENT

03 LIST



INFINITEPLAY

No limits system



Z7000.40

InfinitePlay is a genuine **100% full native IP system**, entirely designed and made in Italy. InfinitePlay represents the latest development in video door phone system in terms for home security and building control.

Thanks to IP connection technology, there are no limits to the distances between system components.

One single system can connect several homes to satisfy the needs of residential, company, offices, services, building complex and even skyscraper applications.

InfinitePlay uses only one communication protocol (TCP/IP), only one type of cable (CAT5 standard) and only one type of connector (**RJ45**) to achieve a significant reduction in cabling costs.

100%
FULL
NATIVE IP
SYSTEM



Designed &
Made in Italy

InfinitePlay can connect an unlimited number of devices including entrance panels, video door phones and reception switchboards.

The **NEXT 7"** capacitive touch-screen LCD monitor is a genuine **Android™** terminal with a simplified menu and intuitive icons for using the many available functions and for accessing a range of services in the most user-friendly way.

InfinitePlay can be installed as a complete new system or as an extension to existing IP systems, even using the cabling already in place.

Functions and services



Z7000
Black & White



WHY ANDROID™?

InfinitePlay uses the Android App™ operating system, which offers users a number of advantages. Android™ allows the development of a simple, functional and user-friendly interface for controlling all frequent tasks.

InfinitePlay is able to communicate and interact intelligently with many common security and home & building automation systems.

Fast and top quality graphics!

InfinitePlay represents a totally plug & play solution, as no special competences or knowledge of IP networks is required to install it. To set up the system, all the installer needs to do the first time he switches on any device, is to activate it by entering its position (building, floor, apartment, and unit number).

THE BEST PLUG & PLAY SOLUTION AVAILABLE

InfinitePlay system devices do not require separate connections to mains power since they are **powered** by the IP network using PoE technology.

Only door opening devices are powered from the mains, a solution chosen to maximise security since, as it makes it impossible to open a door by breaking into an entrance panel and accessing the opening contacts.

InfinitePlay's full IP technology even allows different buildings to be inter-connected so that centralised night-time surveillance can be provided from the switchboards.

Applications

The InfinitePlay system can satisfy the communication and security needs of all applications: home, offices, industrial and services.



HOUSE
VILLA



TWO-FAMILY RESIDENCE
THREE FAMILY RESIDENCE
FOUR FAMILY RESIDENCE

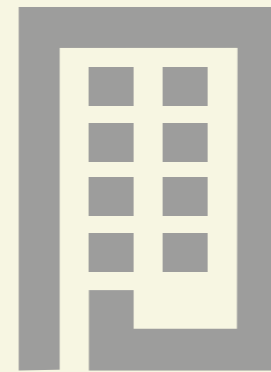

APARTMENT BLOCKS
RESIDENCES
OFFICES
SCHOOLS
UNIVERSITIES

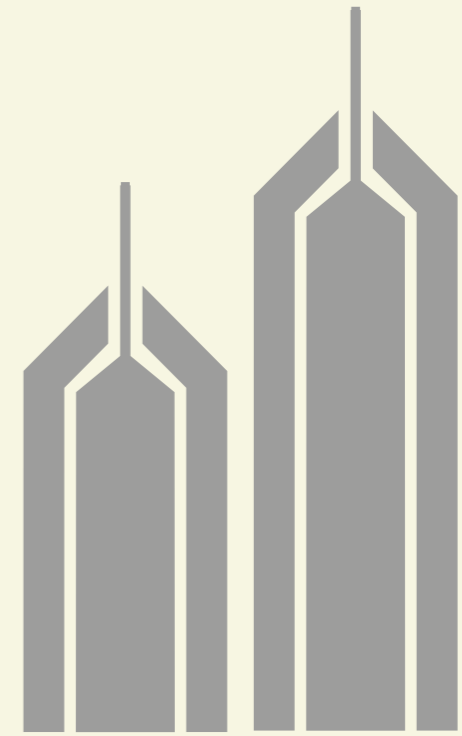

BUILDING COMPLEXES
HOSPITALS
PRISONS
AIRPORTS
SKYSCRAPERS

WHAT CAN I DO WITH INFINITEPLAY?

SEE WHO HAS RUNG THE BELL. OPEN THE DOOR and **SWITCH THE LIGHTS ON**

CONTROL MOVEMENTS THROUGH ALL ACCESS POINTS

Control the opening and closing of **DOORS, GATES AND GARAGE DOORS**

Make **VIDEO CALLS** to other video door phones in the system

LISTEN TO THE VOICEMAIL of people who rang the bell while you were out

Check and control **INDIVIDUAL LIGHTS OR LIGHT GROUPS**

Configure an **AUTOMATIC REPLY TO THE ENTRANCE PANEL** for people calling outside office hours

FORWARD ENTRANCE PANEL CALLS AND CONTROL LIFT MOVEMENTS from the reception switchboard

SEND MESSAGES, ATTACHMENTS AND SERVICE INFORMATION to internal users from the **MANAGEMENT OFFICE**

VIEW CRITICAL AREAS AND PLACES monitored by video cameras from the Guard Office

MONITOR ENTRANCE PANEL VIDEO CAMERAS and any **AUXILIARY CAMERAS**

REPLY TO THE VIDEO DOOR PHONE FROM YOUR MOBILE over the Wi-Fi network

CHECK THE FUNCTIONING OF THE CCTV SYSTEM

MANAGE PANIC ALARM from reception switchboard



VIDEO DOOR PHONE SYSTEM



Flat



Next

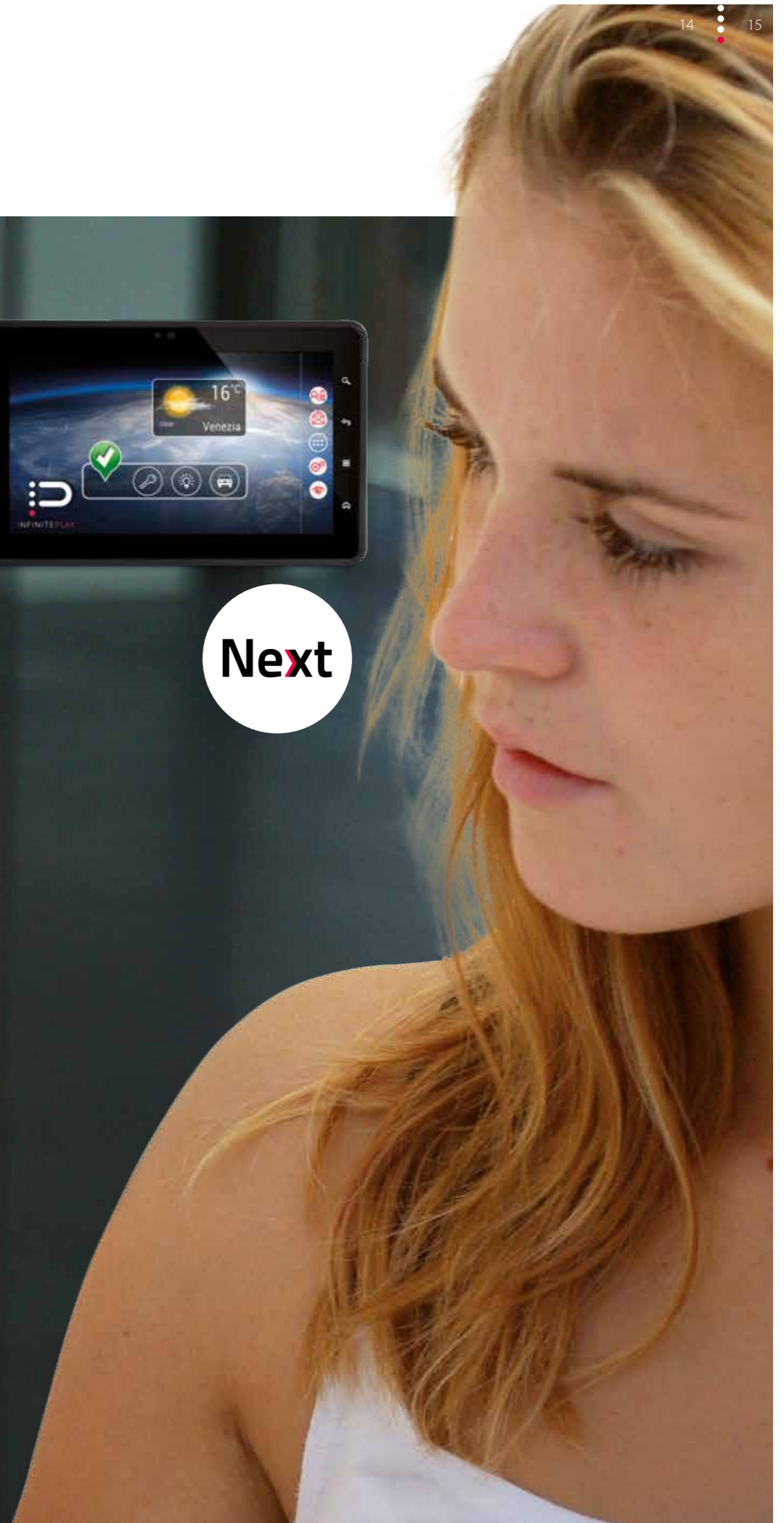

Flat

InfinitePlay entrance panels are designed to withstand vandalism, heavy rain and the worst weather. The front cover is made from **AISI 316 Scotch Brite brushed stainless steel** to resist even the most aggressive atmospheres.

Glass parts are made from ultra-strong, scratch-proof glass.

Technical specifications

- 5 mpx video camera for high resolution images and superb contrast in all lighting conditions
- 4 high-efficiency LEDs for night-time illumination
- RJ45 connector with PoE power supply
- Dimensions 262 x 95 mm, only 19 mm thick
- No special back boxes required. The Entrance Panel can be installed in standard vertical 3-module back boxes or round back boxes
- Visitor detection sensor
- Optional rain cover surround
- Various aesthetic finishes
- The Entrance Panel can be installed using most commercial back boxes

Versatility

Two types of keypad are available, both with no moving parts.

Z1001 with illuminated name buttons for 1 to 4 user systems.

Z100D with touch-screen for scrolling name searches and for displaying additional information like the floor and staircase number of offices. Thanks to touch-screen technology, there are no limits to the number of internal users.

Comfort

The generous **4.3" sun-readable display** allows users to communicate with visitors via images and status messages (e.g. "calling", "talking", "door opening", "call ended").

You can also record an **automatic answer** on your video door phone to display to visitors at the entrance panel. This is an extremely useful function for shops and offices wishing to display their opening days/times.

The microphone uses **noise cancelling** technology to eliminate background noise from busy roads.

The touch-screen display also provides a numeric keypad for opening doors by entering a pre-programmed code. Doors can also be opened via **InfinitePlay** app on your smartphone.



Touch screen Entrance panel

Noise cancelling microphone

5 megapixel video camera

IP54
Protection degree against water and dust.

IK07
Impact degree resistance.

Sun-readable 4.3" touch-screen

Entrance panel 1 to 4 touch buttons

Z1001

Z100D

Designed & Made in Italy

Mario Bianchi	Mario Bianchi	Mario Bianchi	
Martin Cooper	Martin Cooper		Mario Bianchi
Michelle Jane		Martin Cooper	
Williams Abe	Michelle Jane		

Colours

The front cover is in AISI 316 Scotch Brite brushed stainless steel.



Z100D / Z100P
Stainless Stell



Z1000.20
Copper



Z1000.30
Brass



Z1000.40
Nickel

Flat

Flush mount

Versatility

Two types of keypad are available, both with no moving parts.

Z2001 with illuminated name buttons for 1 to 4 user systems.

Z200D with touch-screen for scrolling name searches and for displaying additional information like the floor and staircase number of offices. Thanks to touch-screen technology, there are no limits to the number of internal users.

Technical specifications

- 4 high-efficiency LEDs for night-time illumination
- RJ45 connector with PoE power supply
- Dimension 310 x 130 x 2 mm

Comfort

The generous **4.3" sun-readable display** allows users to communicate with visitors via images and status messages (e.g. "calling", "talking", "door opening", "call ended").

You can also record an **automatic answer** on your video door phone to display to visitors at the entrance panel. This is an extremely useful function for shops and offices wishing to display their opening days/times.

The microphone uses **noise cancelling** technology to eliminate background noise from busy roads.

The touch-screen display also provides a numeric keypad for opening doors by entering a pre-programmed code. Doors can also be opened via **InfinitePlay** app on your smartphone.



Z9092

BACK BOX 2 MODULE FOR FLAT FLUSH MOUNT ENTRANCE PANEL Z2001 - Z200D

Z200D

Thickness 2 mm
off the wall.

Camera
5 Megapixel

MIC
noise cancellation

Presence Sensor
able to welcome the visitor.

IP54
Protection degree against water and dust.



IK07
Impact degree resistance.



PoE
Power over ethernet

Security
Anti-theft fixing.

Structure

The front cover is able to resist even the most aggressive atmospheres.

Wide Display
4,3" sun-readable.



Next



Designed & Made in Italy



Z7000.40
Total Black



AVAILABLE IN TOTAL BLACK OR BLACK & WHITE TO MATCH THE LATEST TRENDS IN INTERIOR DESIGN.

Thin, and modern looking, the NEXT hands-free monitor style video door phone incorporates a generous 7" TFT LCD capacitive touch-screen, and is designed for semi-recessed wall mounting.

With its essential, contemporary looks and low-profile, close-to-the-wall design, the NEXT monitor is ideal for installation in all sorts of environment. Its flat shape makes it suitable for even the most stylish rooms.

Versatility

The monitor is mounted on a stainless steel plate, which comes as part of the kit. A recessed back box must be fitted in the wall. This can be a three module back box, arranged vertically or horizontally, or a round back box.

The monitor can also be installed in other common back box types.

Confort

The monitor is easy to use thanks to the Video Door Phone Android app with a dedicated widget on the home page. The screen itself is made from ultra-strong, scratch-proof and easy to clean glass.

A 5 mpx entrance panel video camera and iMX6 quad-core processor ensure full HD, 30 fps video image quality.

Excellent audio quality thanks to **noise cancelling technology.**



Z7000
Black & White

- Z7000** NEXT IP 7" HD TOUCH SCREEN WHITE
- Z7000.40** NEXT IP 7" HD TOUCH SCREEN BLACK
- Z7100** NEXT IP 7" HD TOUCH SCREEN WITH CAMERA WHITE
- Z7100.40** NEXT IP 7" HD TOUCH SCREEN WITH CAMERA BLACK

Technical specifications

- RJ45 connector with PoE power supply
- Semi-recessed monitor with 7" TFT LCD capacitive touch-screen WVGA 800 x 480 Cr500 with ultra-strong glass screen
- Fast and powerful thanks to an iMX6 quad-core processor
- 2 mpx video camera for video intercom functions on Z7100
- Mini USB 2.0 port for uploading images, backgrounds and message attachment files
- Automatic answer
- Browser
- Android operating system
- Dimensions 189 x 119 mm, only 21 mm thick



100% FULL IP

PLUG AND PLAY



System components

The backbone of the system consists of just a few simple and versatile components capable of satisfying the needs of all types of installation, including home, condominium, building complex and service systems. InfinitePlay is so simple that anybody can design their own system and select the components they need.

The Z6001 main power supply is sufficient for up to 4 internal and external devices and even has a free port for connection to the internet. This allows all the devices in the system to access internet services and permits connection to the system from a remote location.

If more than 4 internal or external devices are connected to the system, the following supplementary power distribution units can be added:

- Art. **Z60DV** for power distribution to monitors (floor networks)
- Art. **Z60DT** for power distribution to entrance panels and reception switchboards

Z6001

POWER SUPPLY FOR SINGLE HOME / CONDOMINIUM

Z60DV

POWER DISTRIBUTION UNIT FOR VIDEO DOOR PHONES, 4 POE OUTPUTS

Z60DV.2

POE SWITCH POWER DISTRIBUTION UNIT WITH 4 OUTPUTS FOR INDOOR AND OUTDOOR UNITS

Z60DT

POWER DISTRIBUTION UNIT FOR ENTRANCE PANELS AND CONCIERGE STATION, 4 POE OUTPUTS

Z600F

POWER DISTRIBUTION UNIT FOR FIREWALLS, 4 POE OUTPUTS



Designed & Made in Italy

If a multi-home system is to be connected to the internet, the Z600F firewall power distribution unit must be installed to protect the connection and ensure data security.



BUILDING MANAGEMENT

All InfinitePlay functions can be managed by a reception service using PC software with a simple graphic interface. The software is also available for LCD touch-screen monitors. Software for reception switchboard connected to Z60DT power distribution unit.



The following is a list of the main functions the reception service can fulfil:

Lobby- control / reception, for receiving calls from entrance panels and transferring them to the relevant users, opening doors and monitoring the entire building complex from a dedicated terminal (appointments, alarms, visitor movements, logs, etc.).

Management Office, for managing internal user relations, and calling or messaging users to provide important news for the building complex (e.g. planned interruptions to utility supplies, gate maintenance work, etc.). Messages can include jpg or pdf attachments.

Guard office, for ensuring the internal security of the entire building complex. This function lets you monitor images captured by all the video cameras connected to the system and manage areas like swimming pools, crèches and shops.



InfinitePlay incorporates a **Messaging system** that permits written communication (even with jpg or pdf file attachments) between internal users or between users and the reception service. A message log is saved on each device.



For more complex systems, especially those in high-rise buildings like skyscrapers, InfinitePlay also provides an interface for **controlling lift movements**.

The system allows incoming visitors to find a lift at ground level and find one waiting for them at their floor when they leave.



The NEXT 7" video door phone monitor can also send **panic alarm** messages to the reception service to call medical assistance immediately.

SYSTEM PROGRAMMING SETUP



Programming the InfinitePlay system is beautifully simple. No additional device is needed to program small and medium systems. They can be programmed from the system's main monitor or any other connected monitor.

The large 7" NEXT monitor features a guided configuration menu with 5 options for setting up all the components in the system.

In more complex installations, a PC can be connected to any one of the devices in the system backbone using any available RJ45 port.

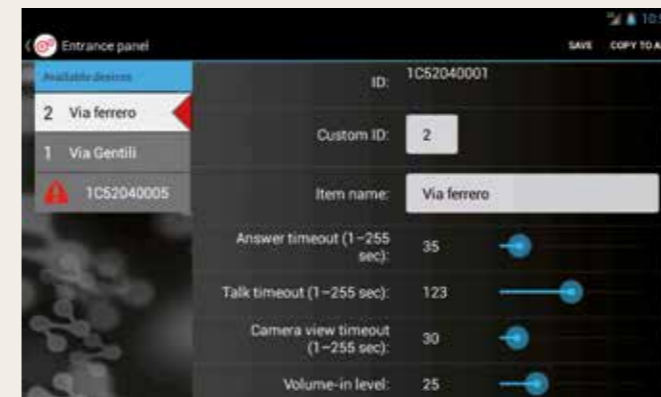
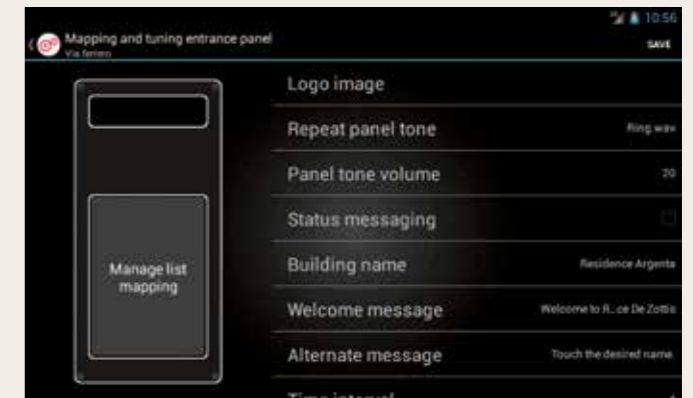
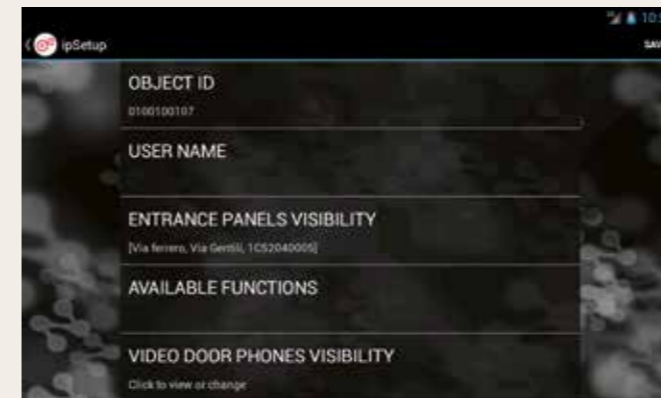
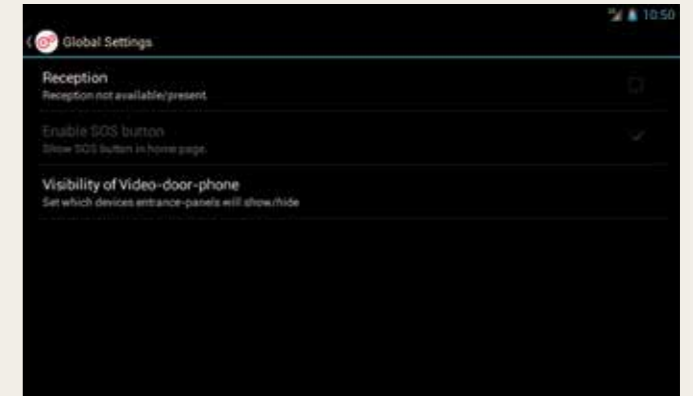
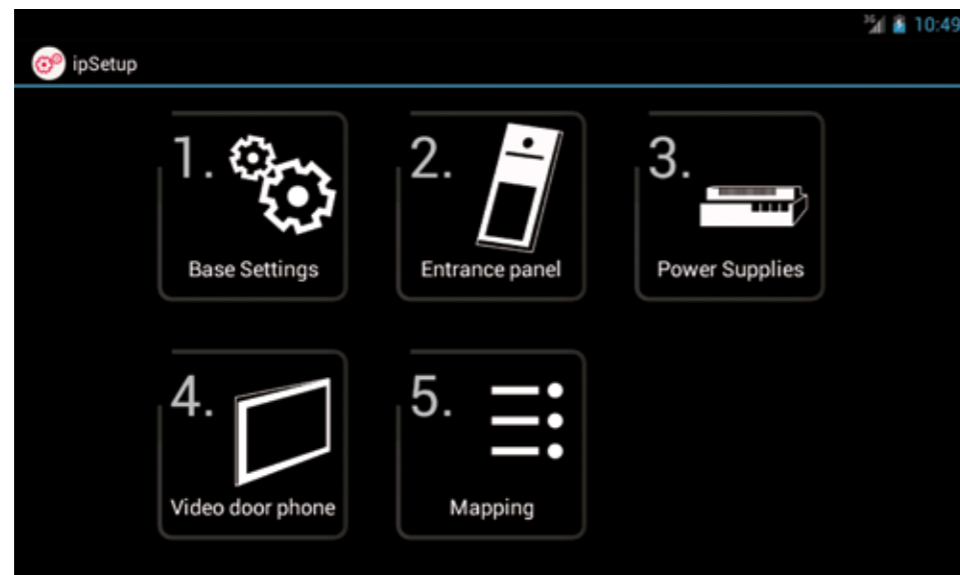

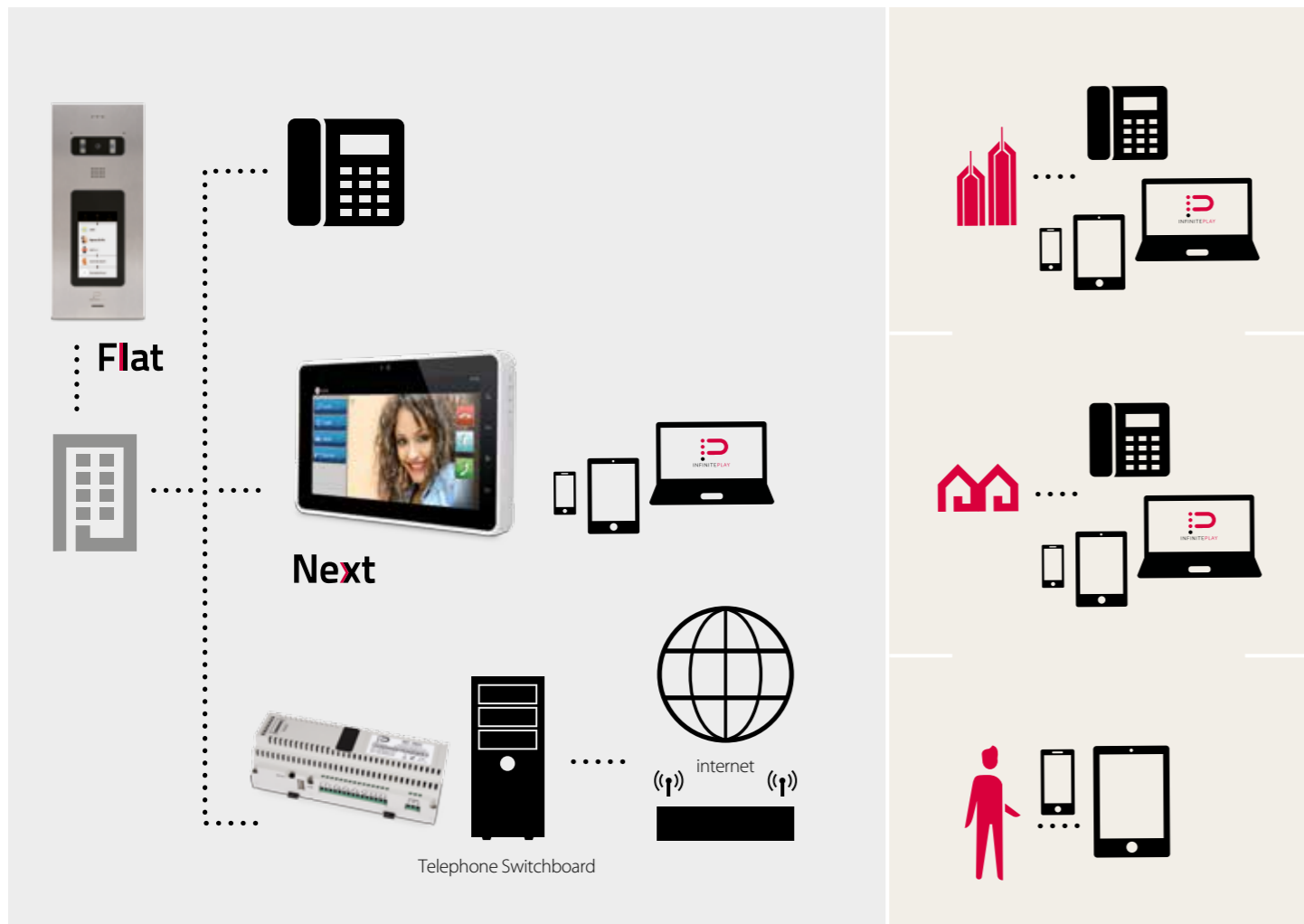

REMOTE SERVICE



The InfinitePlay app lets you see callers from the comfort of your lounge or even from the garden. InfinitePlay lets you receive audio and video calls from the entrance panel directly on your smartphone or tablet. You can even view video camera images, control actuators, open doors and call other devices on the system.



All video door phone functions are easily accessible from your smartphone or tablet.



OPEN TO STANDARD SIP

InfinitePlay is a SIP compatible system that meets the increasing demand of video door entry systems using IP networks.

Thanks to this feature, we are able to enter VOIP world where the possibilities of communication are infinite and with no limits.

It is easy to activate a new SIP Client by simply adding a "Z95IP" license on InfinitePlay server "Z6001".



SOFTWARE LICENSE FOR SIP DEVICE





System diagnostics

Diagnostic web service lets you verify the correct operation of all connected devices. The software can be run locally from a PC connected to the system or remotely, if the system is connected to the internet.

This useful feature rapidly analyses system functioning and permits major savings in service times and costs by immediately identifying any component in need of replacement.

This ensures fast and efficient service from installer-stipulated technical assistance contracts. The diagnostic function lets you view all the operations processed by the system.

Advance diagnostic web service for InfinitePlay systems.

Connection diagrams

 SINGLE FAMILY VIDEO DOOR PHONE SYSTEM CONSISTING OF AN ENTRANCE PANEL, POWER SUPPLY AND 7" MONITOR.



Art. Z7000

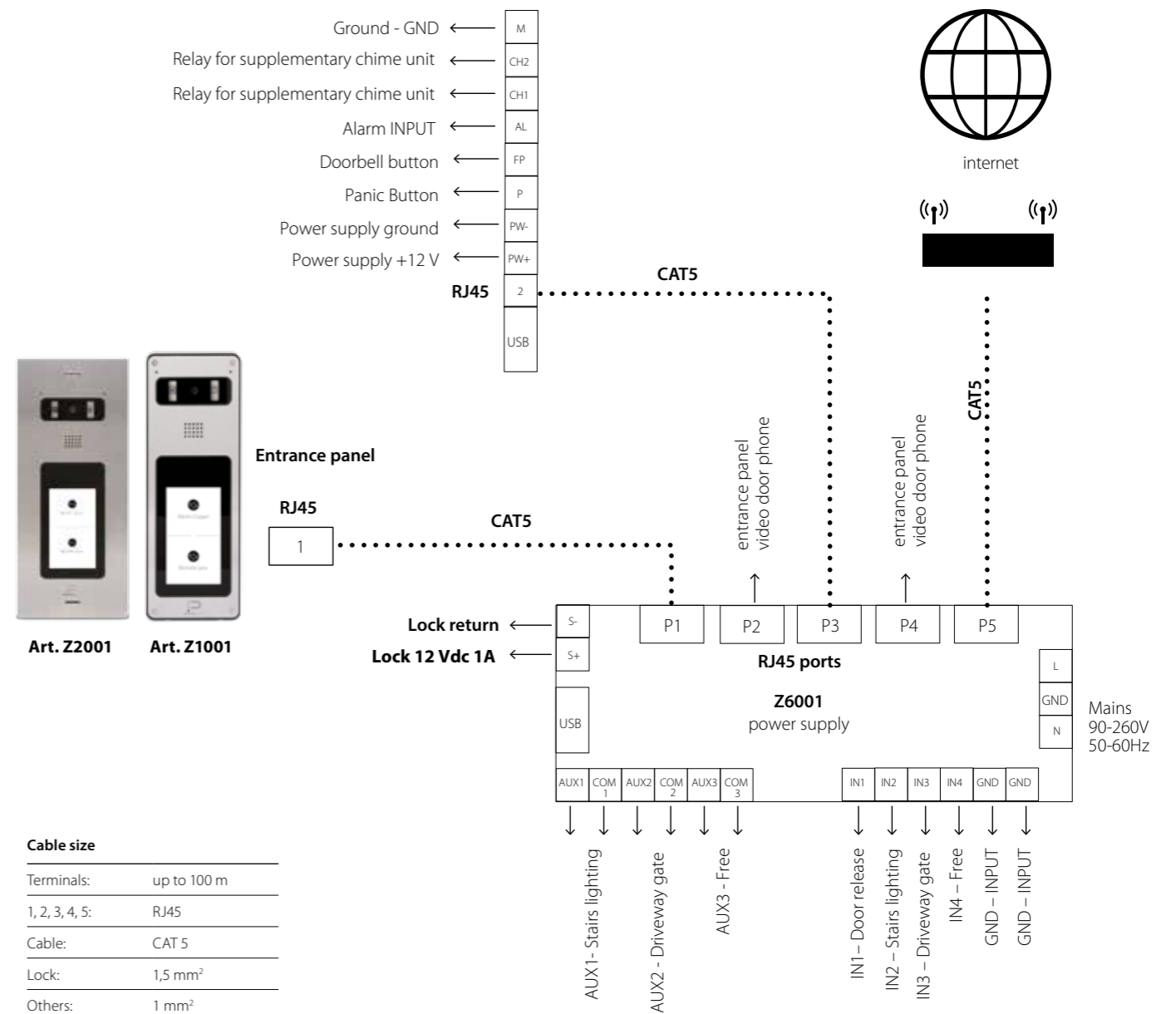

Connection diagrams



TWO FAMILY VIDEO DOOR PHONE SYSTEM CONSISTING OF AN ENTRANCE PANEL WITH TWO NAME BUTTONS, POWER SUPPLY, MONITOR 1 AND MONITOR 2 WITH INTERNET CONNECTION

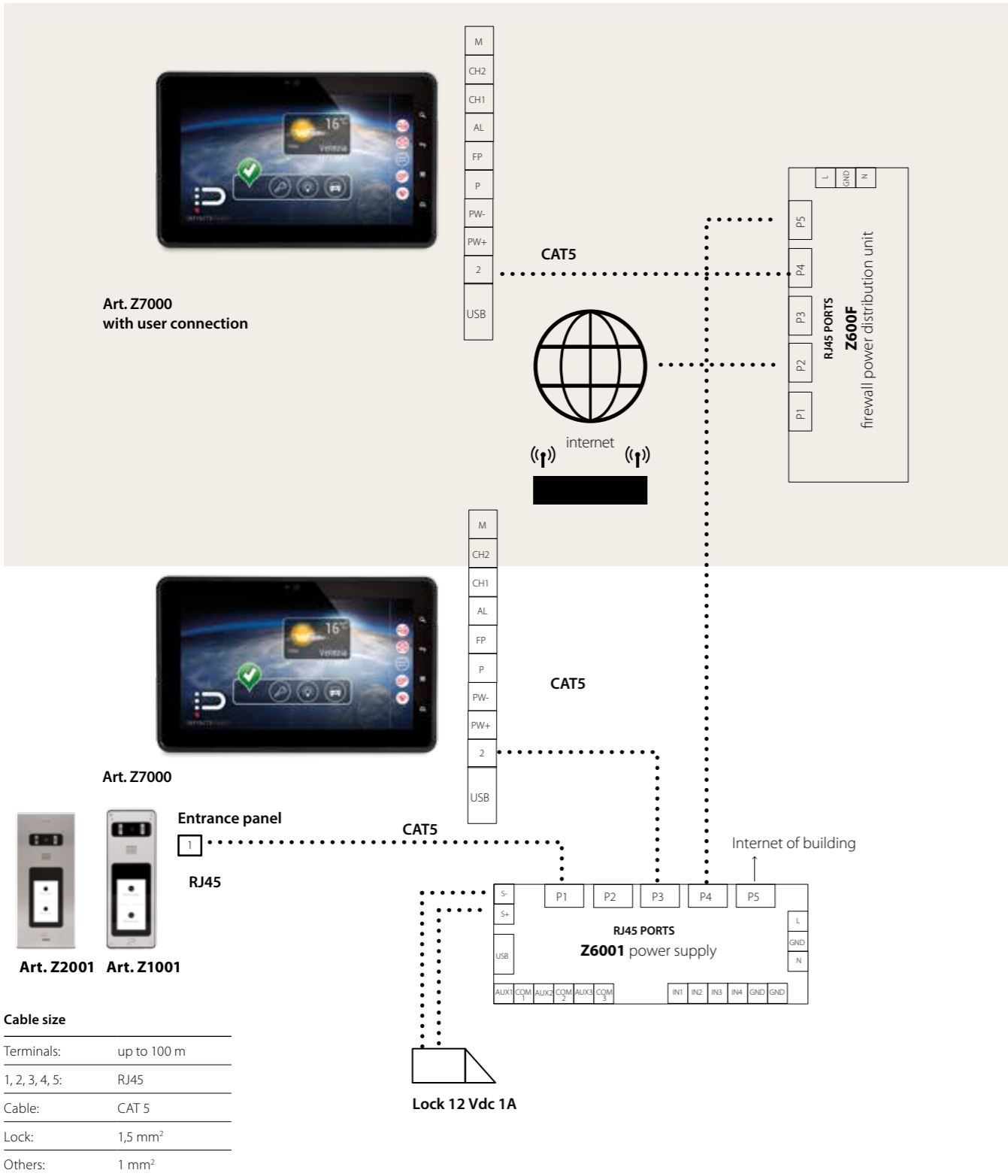

MULTIFAMILY VIDEO DOOR PHONE SYSTEM CONSISTING OF AN ENTRANCE PANEL WITH DISPLAY, POWER SUPPLY, POWER DISTRIBUTION UNITS WITH TWELVE MONITORS.

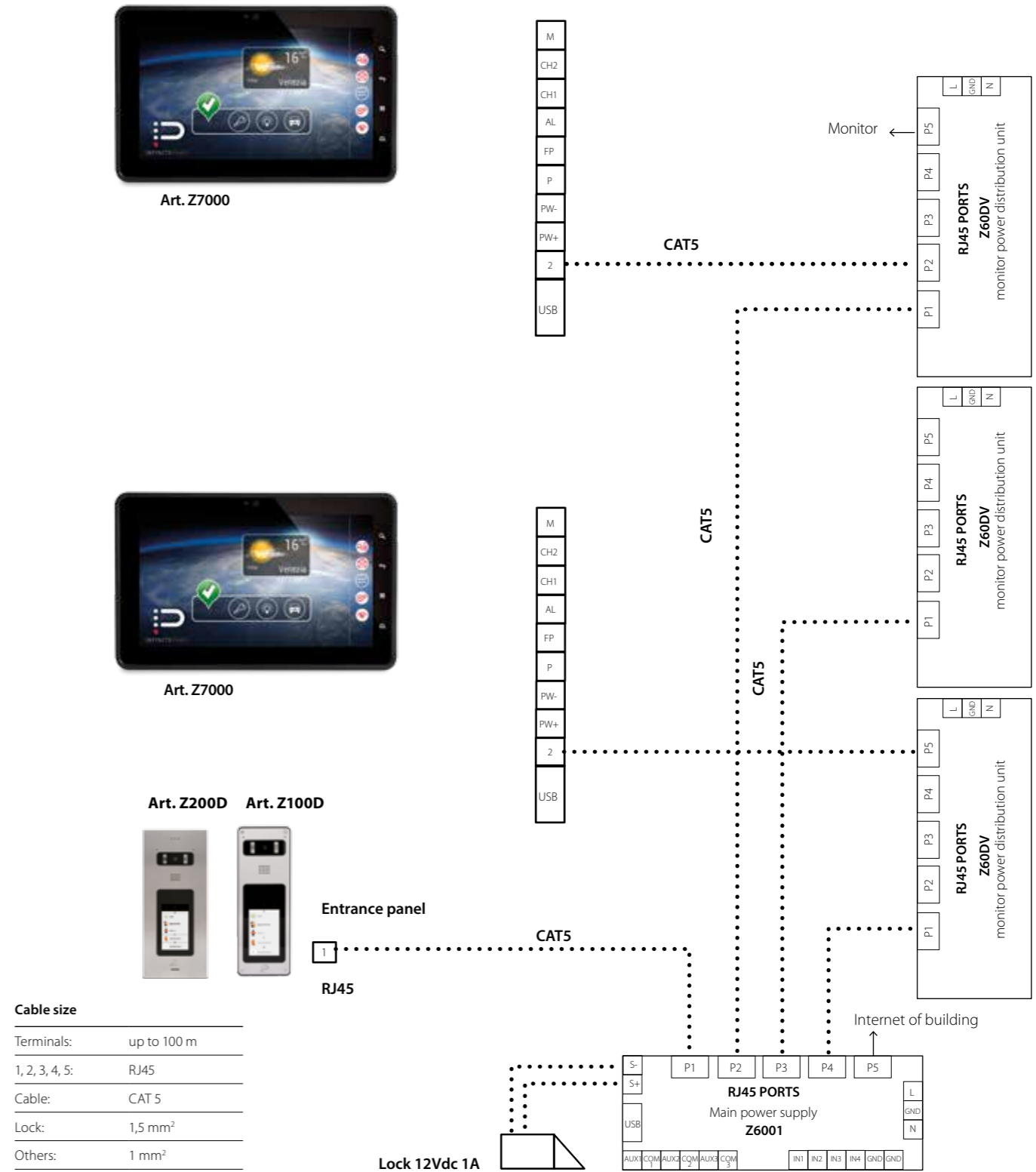

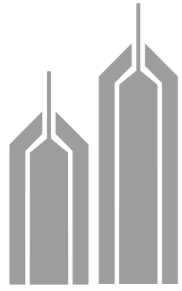

BUILDING COMPLEX SYSTEM CONSISTING OF TWO ENTRANCE PANELS, POWER SUPPLY, RECEPTION SWITCHBOARD AND POWER DISTRIBUTION UNITS



Art. Z7000

Art. Z100D



Art. Z200D

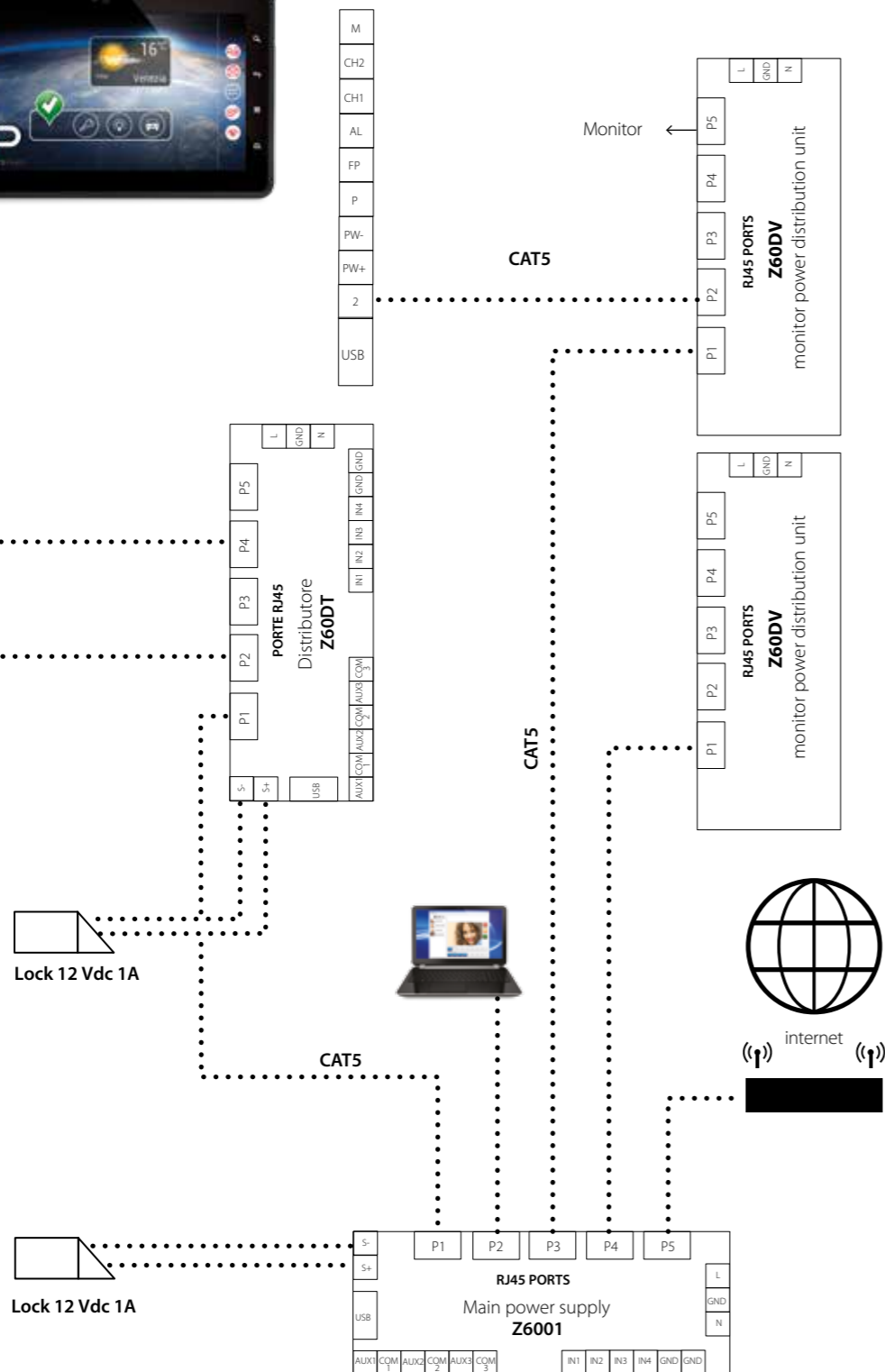

Cable size	
Terminals:	up to 100 m
1, 2, 3, 4, 5:	RJ45
Cable:	CAT 5
Lock:	1,5 mm ²
Others:	1 mm ²

External Units



Z1001

Audio/video entrance panel in AISI 316 stainless steel, with 1 to 4 touch buttons, electronic IP module, colour video camera with 5 mpx sensor and white LED illumination. Dimensions 262 x 95 x 19 mm.



Z100D

Audio/video entrance panel in AISI 316 stainless steel, with 4.3" sun-readable touch screen display, electronic IP module, colour video camera with 5 mpx sensor and white LED illumination. Dimensions 262 x 95 x 19 mm.



Z100P

Rain-proof frame in AISI 316 stainless steel for Z1001 - Z100D entrance panels.



Z100E

Surface mounting box with rainproof frame in stainless steel.



Z1000.10

Replacement Audio/video front cover in brushed STAINLESS STEEL finish for Z1001 - Z100D entrance panels.



Z1000.20

Audio/video front cover in COPPER finish for Z1001 - Z100D entrance panels.



Z1000.30

Audio/video front cover in BRASS finish for Z1001 - Z100D entrance panels.



Z1000.40

Audio/video front cover in NICKEL finish for Z1001 - Z100D entrance panels.



ZT503

Back box for entrance panels Flat and Video intercom Next.

External Units



Z2001

Audio/video FLAT FLUSH MOUNT entrance panel in AISI 316 stainless steel, with 1 to 4 touch buttons, electronic IP module, colour video camera with 5 mpx sensor and white LED illumination.



Z2001.20

Flat flushmount entrance panel inox audio/video 1/4 touch buttons in copper finish.



Z2001.30

Flat flushmount entrance panel inox audio/video 1/4 touch buttons in brass finish.



Z2001.40

Flat flushmount entrance panel inox audio/video 1/4 touch buttons in nickel finish.



Z200D

Audio/video FLAT FLUSH MOUNT entrance panel in AISI 316 stainless steel, with 4.3" sun-readable touch screen, electronic IP module, colour video camera with 5 mpx sensor and white LED illumination.



Z200D.20

Flat flushmount entrance panel inox audio/video 4,3" touch screen display in copper finish.



Z200D.30

Flat flushmount entrance panel inox audio/video 4,3" touch screen display in brass finish.



Z200D.40

Flat flushmount entrance panel inox audio/video 4,3" touch screen display in nickel finish.



Z9092

Back box 2 module for FLAT FLUSH MOUNT entrance panel Z2001 - Z200D

Power Supplies and Accessories



Z6001

PoE power supply for villas and condominiums in DIN casing with 12 modules for entrance panels and monitors. Power supply 90 - 260 V, 50 - 60 Hz.



Z60DV

PoE power distribution unit with 4 outputs for monitors. 12 modules for DIN casing. Power supply 90 - 260 V, 50 - 60 Hz.



Z60DV.2

PoE Switch power distribution unit with 4 outputs for indoor and outdoor units.



Z60DT

PoE power distribution unit with 4 outputs for entrance panels or reception concierge station. 12 modules DIN casing. Power supply 90 - 260 V, 50 - 60 Hz.



Z600F

Placca audio/video colore RAMATO da usare con Targa Z1001 - Z100D



Z6023

Supplementary 12 V power supply for Z7000 and Z7100 monitors, in DIN casing with 2 modules for monitors NEXT. Power supply 100 - 240 V, 50 - 60 Hz.



Z60RH

Module Relè with 9 output and 8 input 6 modules for DIN casing with PoE or additional power supply Z6023.



Z9400

Software for reception concierge station connected to Z60DT power distribution unit.



Z9SiP

Software license for a device SIP



Z005U

305 mt of CAT5 UTP non-shielded cable for high frequency transmissions in structured cabling systems.

Z005F

305 mt of CAT5 FTP shielded cable for high frequency transmissions in structured cabling systems.



Z950T

Tester LAN cable with RJ45 connection

Internal Video Units



Z7000

Next IP hands-free, two-channel monitor with 7", WVGA resolution, TFT LCD, capacitive touch-screen, in black and white finish. Mounting bracket. Dimensions 189 x 119 x 21 mm.



Z7000.40

Next IP hands-free, two-channel monitor with 7", WVGA resolution, TFT LCD, capacitive touch-screen, in black finish. Mounting bracket supplied as standard. Dimensions 189 x 119 x 21 mm.



Z7100

Next IP hands-free, two-channel monitor with 2 mpx video camera and 7", WVGA resolution, TFT LCD, capacitive touch-screen, in black and white finish. Mounting bracket supplied as standard. Dimensions 189 x 119 x 21 mm.



Z7100.40

Next IP hands-free, two-channel monitor with 2 mpx video camera and 7", WVGA resolution, TFT LCD, capacitive touch-screen, in black finish. Mounting bracket supplied as standard. Dimensions 189 x 119 x 21 mm.



Z7045

Replacement bracket for Next Z7000 - Z7100.



Z700A

Desktop base for Next Z7000 - Z7100



ZT503

Back box for entrance panels Flat and Video intercom Next.

Kits



ZK171

InfinitePlay IP video door phone kit including one Z1001 entrance panel with one touch button, one white Z7000 monitor and one Z6001 power supply. Pre-programmed in the factory.



ZK171.40

InfinitePlay IP video door phone kit including one Z1001 entrance panel with one touch button, one black Z7000.40 monitor and one Z6001 power supply. Pre-programmed in the factory.



ZK17D

InfinitePlay IP video door phone kit including one Z100D entrance panel with display, one Z7000 white monitor and one Z6001 power supply server SIP.



ZK17D.40

InfinitePlay IP video door phone kit including one Z100D entrance panel with display, one Z7000.40 black monitor and one Z6001 power supply server SIP.



ZK271

InfinitePlay IP video door phone kit including one Z2001 entrance panel with one call button, one Z7000 white monitor and one Z6001 power supply.



ZK271.40

InfinitePlay IP video door phone kit including one Z2001 entrance panel with one call button, one Z7000.40 black monitor and one Z6001 power supply.



ZK27D

InfinitePlay IP video door phone kit including one Z200D entrance panel with display, one Z7000 white monitor and one Z6001 power supply server SIP.



ZK27D.40

InfinitePlay IP video door phone kit including one Z200D entrance panel with display, one Z7000.40 black monitor and one Z6001 power supply server SIP.

Media & Communications



Designed & Made in Italy



ZP003

InfinitePlay suitcase

ZP003

Trolley in aluminium black
 Dimensions: cm 52,5 x 34,5 x 10,5h
 Consists of item working:
 Z1001 Flat entrance panel 1-4 touch buttons
 Z6001 Server SIP Power supply
 Z7000 Next 7" IP video door phone white

ZP001

ZP002



InfinitePlay large panel

ZP001

Dimensions: 150 L x 100 h with legs 200h
 Consists of items working:
 Z1001 Flat entrance panel 1-4 touch buttons
 Z100D Flat entrance panel 4,3" display
 Z6001 Server SIP Power supply
 Z7000 Next 7" video door phone white
 Z7000.40 Next 7" video door phone black

InfinitePlay small panel

ZP002

Dimensions: 60 L x 150 h with legs 200h
 Consists of items working:
 Z1001 Flat entrance panel 1-4 touch buttons
 Z6001 Server SIP Power supply
 Z7000 Next 7" IP video door phone white
 Z7000.40 Next 7" IP video door phone black

InfinitePlay is a trademark of Zealabs Srl.



Via Monte Grappa, 25
31020 Villorba TREVISO - ITALY

T. +39 0422-350680

F. +39 0422-446958

info@infiniteplay.com

www.infiniteplay.com